

Adjustable Minibuffers

EFMA & EFA Series

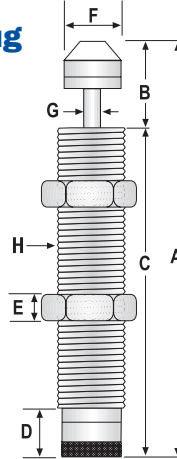

- **Operating Temperature:** 14° to 176°F (-10° to 80°C)
- **Two locknuts provided with each minibuffer**
- **Flange and Footlug mounts available**



EFMA

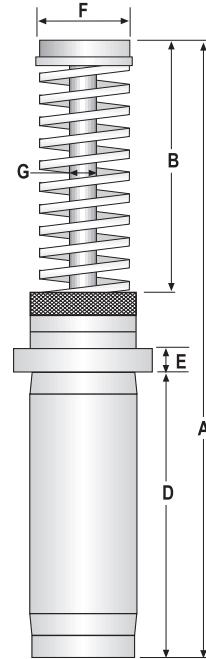

EFA 20-50-FC

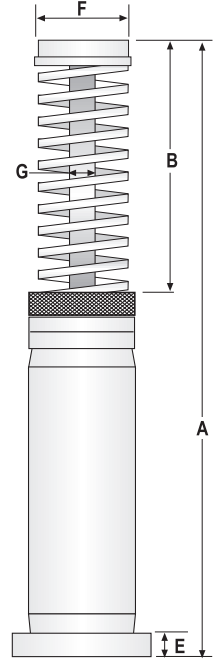

EFA 20-50-RC

EFA Mounting Dimensions

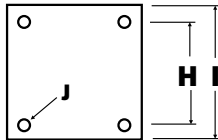

H - 38 (1.50)
I - 50 (1.97)
J - 5.5 (0.22) dia.

SPECIFICATIONS: EFA & EFMA MINIBUFFERS

DIMENSIONS IN INCHES (MM)									
MODEL	STROKE	A	B	C	D	E	F	G	H
EFMA 7-15-1C	.60	4.33	1.01	3.32	.49	.24	.47	.14	5/8-18 UNF (-1)
EFMA 7-15-6C	(15)	(110)	(26)	(84)	(12)	(6)	(12)	(4)	M14 X 1.0 (-6)
EFMA 20-16-1C	.63	5.12	1.18	3.9	.6	.31	.71	.20	3/4-16 UNF
EFMA 10-20-1C	.80	5.08	1.37	3.71	.49	.31	.71	.20	7/8-14 UNF (-1)
EFMA 10-20-6C	(20)	(129)	(35)	(94)	(12)	(8)	(18)	(5)	M20 X 1.5 (-6)
EFMA 11-25-1C	1.0	6.02	1.73	4.29	.47	.39	.87	.35	1-12 UNF (-1)
EFMA 11-25-6C	(25)	(153)	(44)	(109)	(12)	(10)	(22)	(9)	M25 X 2.0 (-6)
EFMA 27-25-6C	2.0	6.14	1.56	4.6	.63	.39	.90	.31	M27 X 3.0
EFMA 27-25-6C	(25)	(156)	(40)	(117)	(16)	(10)	(23)	(8)	
EFA 20-50-FC	2.0	9.06	3.54	-	3.92	.39	1.10	.39	-
EFA 20-50-FC	(50)	(230)	(90)	-	(100)	(10)	(28)	(10)	-
EFA 20-50-RC	2.0	9.06	3.54	-	.63	.39	1.10	.39	-
EFA 20-50-RC	(50)	(230)	(90)	-	(16)	(10)	(28)	(10)	-

SIZE SELECTION														
MODEL	MAX EFFECTIVE WEIGHT				ENERGY PER CYCLE In lbs (Nm)	ENERGY PER HOUR In lbs (Nm)	MAX IMPACT SPEED				SPRING FORCE lbs (kgf)		MAX CYCLES PER MINUTE	WEIGHT lbs. (g)
	STEP 1	STEP 2	STEP 3	STEP 4			In/Sec (m/sec)	EXT.	COMP					
EFMA 7-15-1C	STEP 1	STEP 2	STEP 3	STEP 4	87 (10)	313,200 (35,900)	STEP 1	STEP 2	STEP 3	STEP 4	0.9 (0.4)	2.4 (1.1)	60	.26 (118)
EFMA 7-15-6C	7.5 (3.4)	18 (8)	44 (20)	75 (34)			95 (2.4)	63 (1.6)	39 (1.0)	31 (.8)				
EFMA 20-16-1C	500 (227)				250 (29)	450,000 (50,800)	125 (3.2)				2.0 (0.9)	5.1 (2.3)	30	.48 (218)
EFMA 10-20-1C	STEP 1	STEP 2	STEP 3	STEP 4			STEP 1	STEP 2	STEP 3	STEP 4				
EFMA 10-20-6C	18 (8)	33 (15)	66 (30)	161 (73)	260 (30)	468,000 (52,800)	106 (2.7)	79 (2.0)	55 (1.4)	35 (.9)	2.0 (0.9)	5.1 (2.3)	30	.4 (181)
EFMA 11-25-1C	STEP 1	STEP 2	STEP 3	STEP 4	712 (82)	640,800 (72,300)	STEP 1	STEP 2	STEP 3	STEP 4	4.4 (2.0)	7.1 (3.2)	15	.64 (290)
EFMA 11-25-6C	42 (19)	75 (34)	242 (110)	728 (330)			114 (2.9)	87 (2.2)	47 (1.2)	28 (.7)				
EFMA 27-25-6C	1375 (625)				690 (78)	621,400 (70,200)	79 (2.0)				4.4 (2.0)	7.1 (3.2)	15	.83 (377)
EFA 20-50-FC	2200 (1000)				3472 (392)	1,666,560 (188,100)	118 (3.0)				6.6 (3.0)	18.3 (8.3)	8	2.21 (1000)
EFA 20-50-RC	2200 (1000)				3472 (392)	1,666,560 (188,100)	118 (3.0)				6.6 (3.0)	18.3 (8.3)	8	2.21 (1000)